



GLEN EWIN ESTATE

Est. 1843



CONTENTS

GLEN EWIN ESTATE, OUR WORLD OF WEDDINGS5
THE PLANNING APPROACH6
OUR VENUES8
WHAT'S INCLUDED12
FOOD GLORIOUS FOOD14
BEVERAGES16
WEDDINGS OF WINTER18
INTIMATE WEDDINGS20
CEREMONY PACKAGE22
FLOWERS24
WEDDING STATIONERY25
HIRE ITEMS26
FLOOR PLANS28
TESTIMONIALS32
ESTATE MAP33
OUR GOLD VENDORS34



GLEN EWIN ESTATE, OUR WORLD OF WEDDINGS

Our philosophy is to deliver exceptional experiences born of creativity and expression.

A wedding is the start of a new life chapter; a time when unforgettable memories are made

**Let us embrace your vision
and bring it to life.**

Our iconic Adelaide Hills property is home to several outstanding venues. Offering contrasting aesthetics, each is immersed amongst established gardens and beautiful lakes.

Let our trusted, knowledgeable staff guide you through the planning process and manage every detail seamlessly.

All you and your guests will need to do is enjoy the day.

**YOUR NEW
ADVENTURE
STARTS HERE**

THE PLANNING APPROACH

Your dedicated Glen Ewin Estate coordinator will listen to your vision and work with you to tailor an experience that reflects your personalities.

They will provide guidance, find solutions and plan the pathway to making your day everything you had imagined.

No detail will be left to chance.

This will be a day to remember forever.

TWO SOULS BUT A
SINGLE THOUGHT,
TWO HEARTS THAT
BEAT AS ONE.

John Keats





OUR VENUES

WHERE
THERE IS
LOVE THERE
IS LIFE.

Mahatma Gandhi

Friday / Sunday Special

Ask us how you can save \$1200 off your wedding (T&Cs apply)

- * If you don't meet the minimum numbers please speak to our helpful staff for a personalised quote.

THE PULPSHED

Rustic charm in a truly stunning setting.

Our glorious 178 year old Pulpshed can be found adjacent to the original Glen Ewin Estate homestead. Nestled between old stone buildings, lawns, the hills and a scenic lake.

The baltic pine Pulpshed is ideally suited to larger weddings and will accommodate up to 350 guests.

Maximum numbers - with a dance floor and separate bridal table	
Round tables	140
Rectangle tables	156
Long rows (single trestle)	230
Long Rows (double trestle)	160
Cocktail	350

Minimum numbers (for adult guests)		
Peak season: <i>1 September - 31 May</i>		
Off-peak season: <i>1 June - 31 August</i>		
Day	Peak	Off-peak
Saturday	100	80
Friday / Sunday	90	70
Monday - Thursday	70	60

Venue hire is included as long as the minimum adult numbers are met.



OUR VENUES

IN YOU I'VE
FOUND THE LOVE
OF MY LIFE AND
MY DEAREST
FRIEND.

Friday / Sunday Special

Ask us how you can save \$1200 off your wedding (T&Cs apply)

- * If you don't meet the minimum numbers please speak to our helpful staff for a personalised quote.

THE GATEHOUSE

This picturesque venue offers a contemporary design with earthy textures. The perfect blend of historic character and modern amenity.

The space can be customised to suit a variety of themes and will accommodate up to 160 guests.

The Gatehouse is also perfect for your bridal shower and hens parties. Speak to our staff for our function package.

Maximum numbers - with a dance floor and separate bridal table	
Round tables	96
Rectangle tables	104
Long rows (single trestle)	104
Long rows (double trestle)	80
Cocktail	160

Minimum numbers (for adult guests)		
Peak season: 1 September - 31 May		
Off-peak season: 1 June - 31 August		
Day	Peak	Off-peak
Saturday	80	60
Friday / Sunday	70	50
Monday - Thursday	60	50

Venue hire is included as long as the minimum adult numbers are met.



WHAT'S INCLUDED

I DREAM
OF YOU IN
COLOURS
THAT DON'T
EXIST.

WHAT'S INCLUDED

- Venue hire

Please note, venue hire is included provided minimum adult numbers are met.

- Reception

6 hours for a sit down or a cocktail wedding.

If you would like more time to celebrate speak with our team about extending your reception package.

- Set up and pack down

Completed by our wonderful staff

Venue hire is applicable for outdoor wedding receptions starting from \$3000.



FOOD + DRINK X GUEST NUMBER = QUOTE PRICE

Add venue hire for outdoor wedding receptions

PRE-DRINKS & CANAPÉS

- 30 – 45 minutes garden use for pre-drinks & canapés, extensions available
- Square tables with chairs on the lawns and outdoor area (deck or pergola)
- Patio heaters (if required)
- Access to areas on the property for photos
- Attentive service for bridal party
- PA system
- Barrels for decorations

RECEPTION

- Large selection of varied floor layouts to choose from
- Bridal table with boxed linen
- Gift table with boxed linen
- Wine barrels for decorations
- Cake barrel and knife
- Crockery, cutlery, glassware
- White table linen and napkins
- White Americana chairs
- All staffing
- Standard lighting

CEREMONY

- **Ceremony: complimentary** with your reception - 7 hour package in total
- Garden ceremony
- 36 Americana chairs (additional available for hire)
- Signing table with linen and chairs
- Wine barrels for decoration
- PA system
- Undercover ceremony area in case of inclement weather

FOOD GLORIOUS FOOD

NOTHING BRINGS PEOPLE
TOGETHER LIKE GOOD FOOD.

COCKTAIL

\$130.00 per person

- Antipasto platters served during pre-drinks (subject to change)
- Your selection of 6 canapés
- Cheese boards
- Your wedding cake served on platters

BANQUET SHARING PLATTERS

\$145.00 per person

- 2 x canapés served during pre-drinks
- 3 x main dishes
- 2 x side dishes
- 2 x desserts
- Your wedding cake served on platters to the table

- * Options & selections subject to change
- * We cater for all dietary requirements
- * Optional upgrades or add ons available

A LA CARTE - ALTERNATE

\$150.00 per person

- 2 x canapés served during pre-drinks
- 1 x entrée
- 2 x main dishes (served in an alternate way)
- 1 x shared side dish
- 1 x dessert
- Your wedding cake served on platters to the table

A LA CARTE - CHOICE

\$155.00 per person

- 2 x canapés served during pre-drinks
- 1 x entrée
- 2 x main dishes (guests' choice)
- 1 x shared side dish
- 1 x dessert
- Your wedding cake served on platters to the table

TASTE OF ASIA SHARING BANQUET By The Vermilion Table

\$160.00 per person

- 2 x canapés served during pre-drinks
- 2 x entrées
- 4 x main dishes
- 2 x side dishes
- Your wedding cake served on platters to the table

ASK US ABOUT BESPOKE PACKAGES



BEVERAGES

“REMEMBER
GENTLEMEN,
IT’S NOT
FRANCE WE
ARE FIGHTING
FOR, IT’S
CHAMPAGNE”

Winston Churchill

THE GATEHOUSE PACKAGE

\$60.00 per person - 6 hour package

THE ESTATE PACKAGE

\$70.00 per person - 6 hour package

THE HERITAGE PACKAGE

\$75.00 per person - 6 hour package

ON CONSUMPTION

\$45.00 per person minimum spend

Select from our beverage on consumption drinks list. This minimum spend goes towards your bar tab which is ongoing for the full duration of your wedding.

BESPOKE SELECTION

Speak to one of our friendly staff about bringing your own beverages or a bespoke package.

ADDITIONAL OPTIONS

At Glen Ewin Estate we understand that not all packages suit everyone. Our staff are more than happy to discuss options to fit your needs, such as time extensions, gin or cocktail bar.

* Menu and prices subject to change



FIG GIN
HAND CRAFTED
SOUTHERN HILLS SPIRITS

Horace
SAUVIGNON BLANC
2020

Wild Honey

Wild Honey

Shrimp and vegetable salad

Butter

Bread and jam

Salad

WEDDINGS OF WINTER

AS AUTUMN
LEAVES TURN
THEIR BRILLIANT
HUE, TWO
HEARTS WILL
JOIN AND SAY
I DO.

WHATEVER THE WEATHER

As the seasons change, so does the landscape for which Glen Ewin Estate is renowned.

Green leaves fall, creating a crunchy carpet of autumnal hues; crisp winter days give way to the perfume of flower-filled gardens. Such is the wonder and beauty of nature.

Special rates are available during the cooler, off-peak months and we welcome you to experience Glen Ewin Estate in the season you love most.

A LA CARTE - ALTERNATE

\$105.00 per person

- Antipasto platters served during pre-drinks (subject to change)
- 1 x entrée
- 2 x main dishes (served in an alternate way)
- 1 x shared side dish
- Your wedding cake served on platters to the table

Pair this package with drinks selected from one of our beverage selections.

Offer valid only between 1 June to 31 August and not valid in conjunction with any other offer.



INTIMATE WEDDINGS

If you would prefer a small and intimate wedding, our team will help you plan your perfect day.

VENUE HIRE

- 6 hours
- \$1000.00

CEREMONY

- **Ceremony: complimentary** with your reception - 7 hour package in total
- Garden ceremony
- 36 Americana chairs (additional available for hire)
- Signing table with linen and chairs
- Wine barrels for decoration
- PA system
- Undercover ceremony area in case of inclement weather

Minimum numbers (for adults guests)	
Monday to Thursday	20
Friday	30
Sunday	40

- Terms and conditions
- Not valid in conjunction with any other offer
- Gatehouse venue only
- Enquire about Saturdays

20

RECEPTION

- Large selection of varied floor layouts to choose from
- Bridal table with boxed linen
- Gift table with boxed linen
- Wine barrels for decorations
- Cake barrel and knife
- Crockery, cutlery, glassware
- White table linen and napkins
- White Americana chairs
- All staffing
- Standard lighting

FOOD

A LA CARTE - ALTERNATE

\$130.00 per person

- Platters during pre drinks (subject to change)
- 1 x entrée
- 2 x main dishes (served in an alternate way)
- 1 x shared side dish
- Your wedding cake served on platters to the table

DRINKS

6 hour package

- The Gatehouse Package
\$60.00 per person
- The Estate Package
\$70.00 per person
- The Heritage Package
\$75.00 per person



CEREMONY PACKAGE

Glen Ewin Estate's beautiful grounds can accommodate requests for ceremony only bookings.

Our talented team will work with you to ensure every moment is magic.

CEREMONY

11:00am - 1:00pm

\$1500.00

Inclusions

- 2 hour hire
- Ceremony and access to the gardens for wedding photography use.
- Up to 36 Americana chairs
- Signing table & 2 chairs
- 2 barrels for decorations

Add ons

- Arbour with flowers
- Red carpet
- Additional Americana chairs

Please see our hire item list for further additional items.

Ask our friendly staff about having drinks and canapés post ceremony.



FLOWERS

IF I HAD A FLOWER
FOR EVERYTIME
I THOUGHT OF YOU,
I COULD WALK
IN MY GARDEN
FOREVER.

Alfred Lord Tennyson

IN-HOUSE FLORIST

The charming Mary is a floral visionary, creating exquisite arrangements from her on-site workshop at Glen Ewin Estate.

From the sublimely simple to the luxuriously lavish, Mary can work with all budgets.

Explore her imaginative creations online and book a consultation.

www.marywauchope.com.au



WEDDING STATIONERY



GRAPHIC DESIGN & ILLUSTRATION

Based at her Glen Ewin studio, Kate works with you to create a unique set of wedding stationery and on the day pieces to set the tone for your unforgettable day.

Custom made; invitations, reply cards, name settings, signage, menus, wine labels, table runners, napkins and more. Kate is happy to discuss all items that may be required and any ideas you may have.

Original artwork to capture your day; make wonderful post wedding gifts and lasting memories.

To find out more and to discuss all design aspects visit www.katewauchope.com

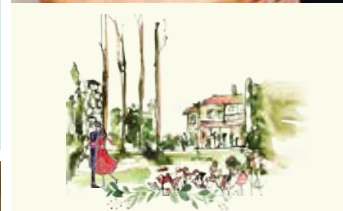

It's time to Celebrate



HIRE ITEMS

MAKE IT EASY

Little extra touches can help cast an enchanting spell over your special day.

From twinkling lights to wishing wells, giant LOVE letters and garden games, we have a collection of items available for daily hire at an additional cost.

If you have other ideas, your resourceful planner can help them become a reality.

IN A HUNDRED
LIFETIMES,
IN A HUNDRED
WORLDS, I'D
CHOOSE YOU.

The Chaos of Stars



FLOOR PLANS

THE PULPSHED

*A few seating suggestions -
if you would like a custom plan
our team are here to help*

Double long rows

*124 people - Suitable for banquet
and A la Carte service*

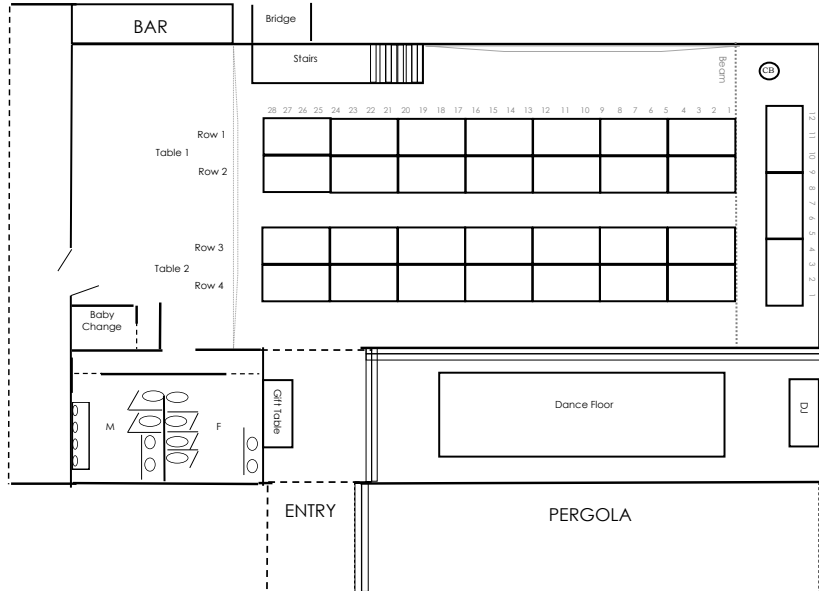

Single long rows

*196 people - Suitable for
A la Carte service*

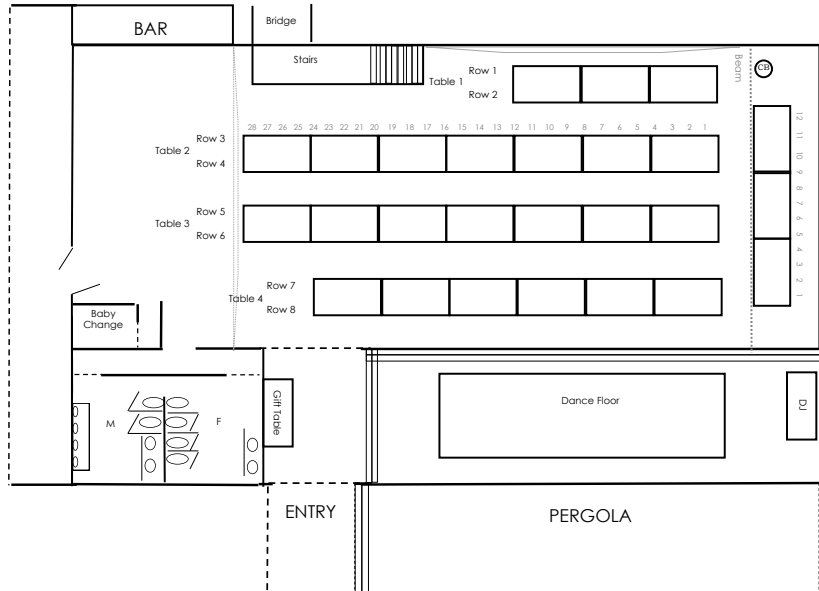

Square tables
 104 people - Suitable for banquet
 and A la Carte service

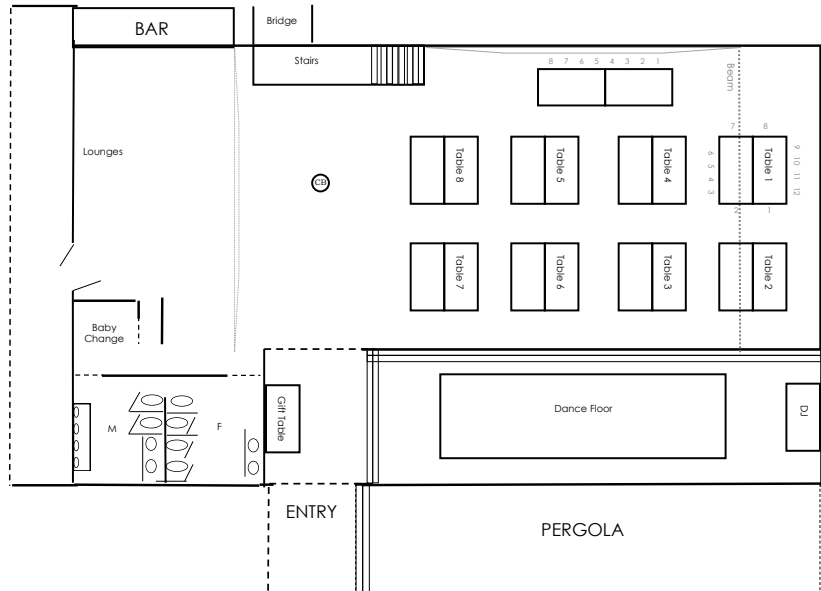

Round tables
 102 people - Suitable for
 A la Carte service

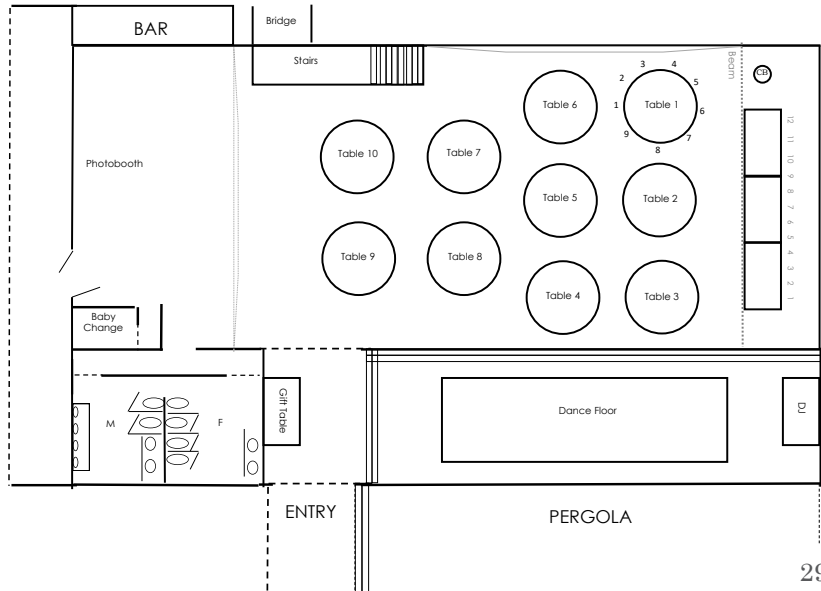

FLOOR PLANS

THE GATEHOUSE

A few seating suggestions - if you would like a custom plan our team are here to help

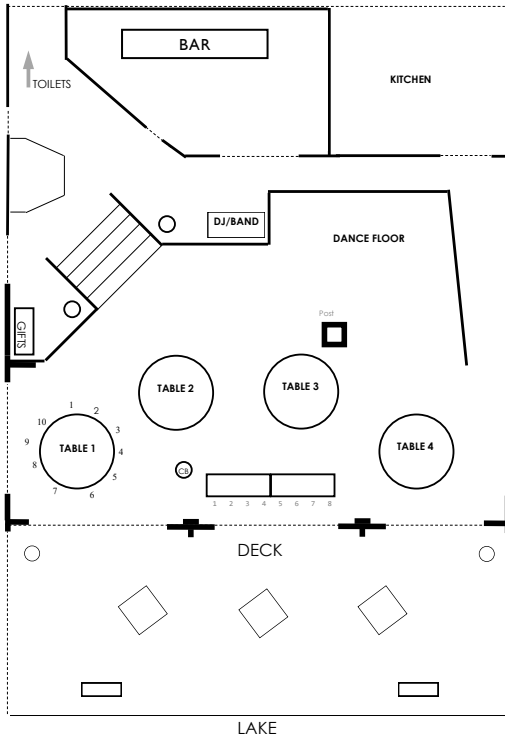

Rounds

48 people - Suitable for A la Carte service

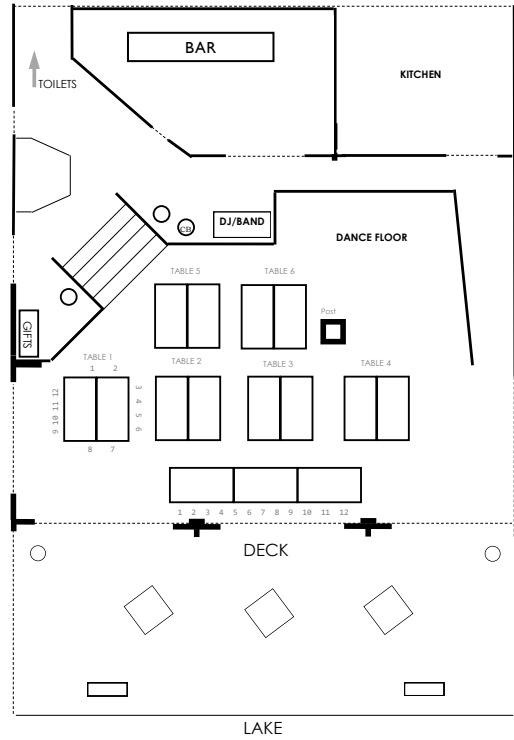

Square tables

84 people - Suitable for banquet and A la Carte service

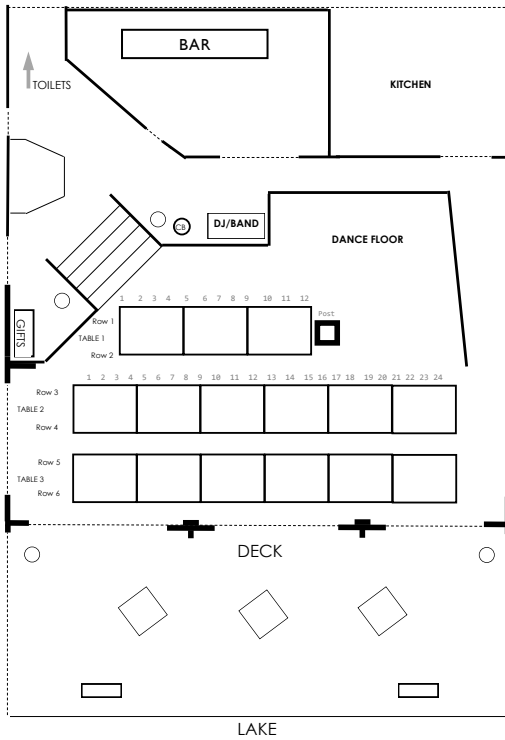

Single long rows

120 people - Suitable for
A la Carte service

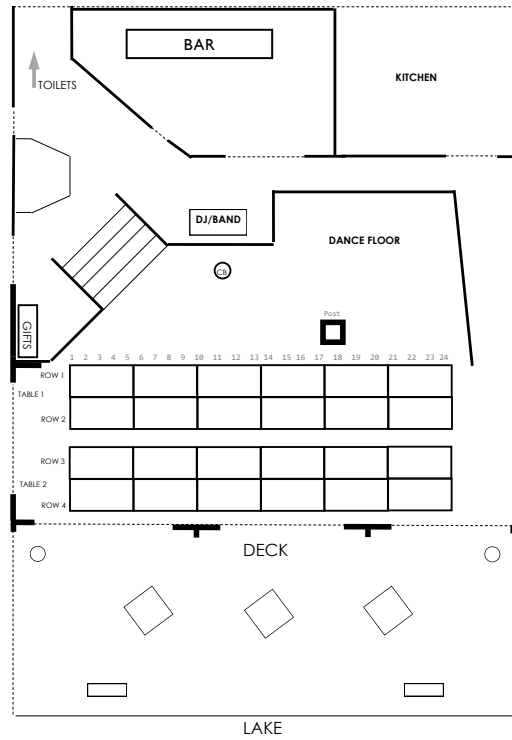

Double long rows

96 people - Suitable for banquet and
A la Carte service

TESTIMONIALS

“Absolutely beautiful setting, amazing delicious food, all of our wedding guests and family utterly enjoyed the whole day!!! Thank you!!!” – A&H

“Our reception was what dreams are made of! Glen Ewin made and created everything we could have asked for. It was amazing, the photos are beautiful, and the smallest of details were met even to the last second.” – E&J

“Our coordinator was so helpful and friendly throughout the entire process.” – L&N

“Was reassuring on the day seeing how incredibly beautiful the venue was and that we had made the best decision in choosing Glen Ewin as our reception venue. To sum it all up, nothing was out of place.” – C&N



Source: www.abia.com.au

ESTATE MAP

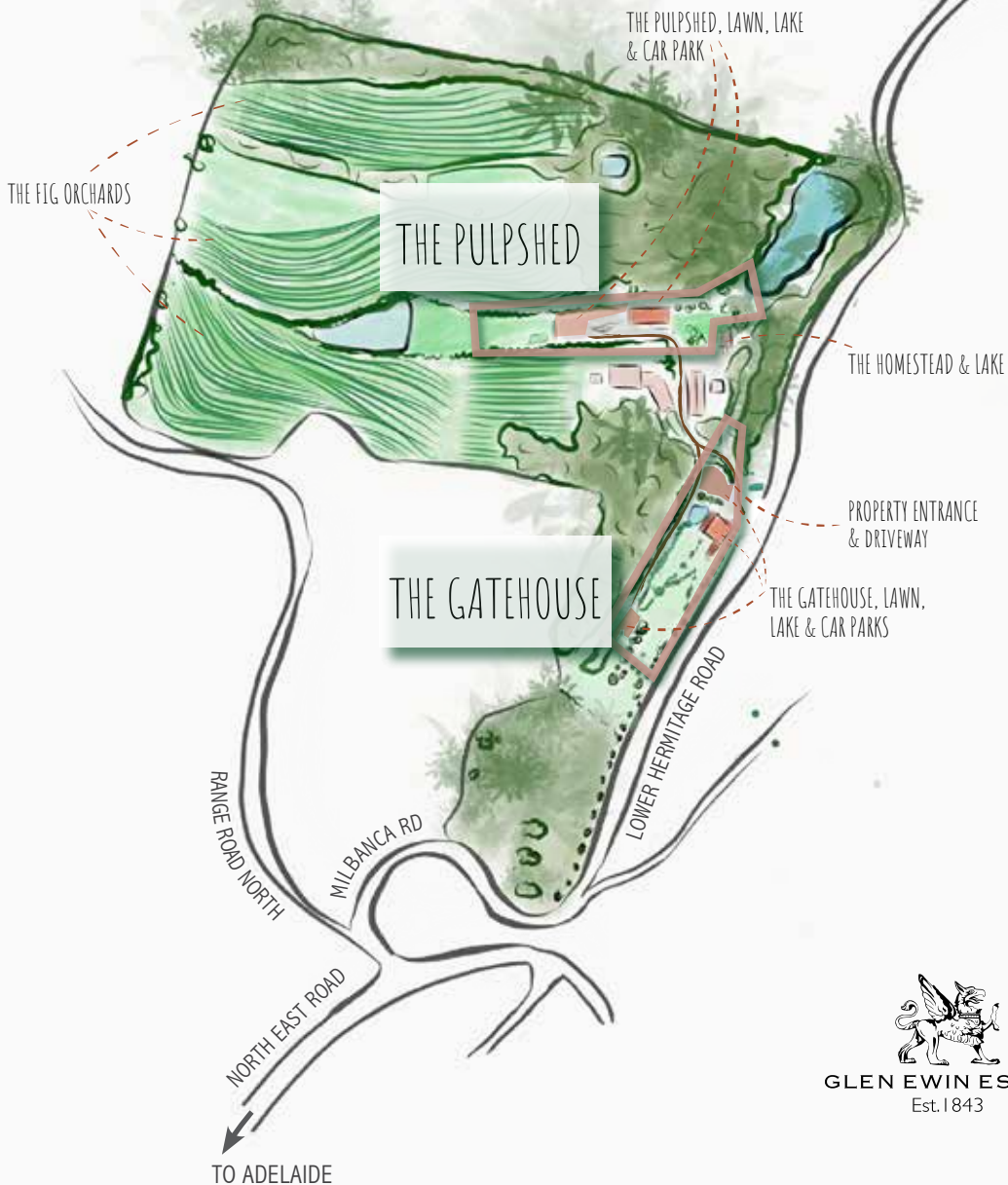

GLEN EWIN ESTATE
Est. 1843

OUR GOLD VENDORS

SIDEWOOD 

Artwine



WAUHOPE DESIGN
GRAPHICS STYLING &
ILLUSTRATION

AMUSE
EVENT LIGHTING
& AUDIO VISUAL



Photo credits:

Andrea Harper, Nicole Motteux, Tim Day, Glen Ewin Estate



GLEN EWIN ESTATE

Est. 1843

43 Lower Hermitage Road, Houghton, 5131, South Australia

t: 08 8380 5657 e: enquiries@glenwinestate.com.au

glenwinestate.com.au

2023 EDITION